

GW304-LP-UNC Low Profile Threaded Insert

Stainless steel 304 · Low profile · Round · Open end · Unified thread
10-32 - 5/16-18

Features

- Designed to provide load bearing threads in thin sheet materials
- Low profile head allows near flush fit to application

Material

- Stainless steel 304

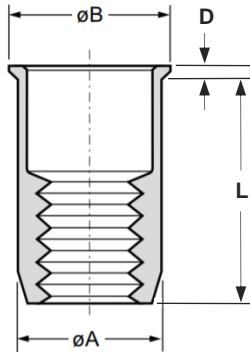

Before Placement

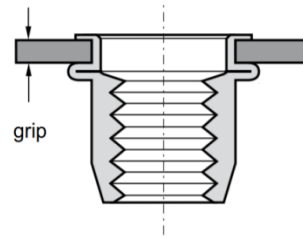

After Placement

Part No.	Thread Size	Grip Range		Hole Size	øA	øB	D	L
		min.	max.	+0.1	-0.02/-0.15	-0.15 / +0.3	-0.05 / +0.3	±0.35
GW304-LP1032-UNC	10-32 UNF	0.5	3.0	7.0	7.0	7.5	0.5	12.0
GW304-LP1420-UNC	1/4-20 UNC	0.5	3.0	9.0	9.0	9.5	0.5	14.5
GW304-LP51618-UNC	5/16-18 UNC	0.5	3.0	11.0	11.0	11.5	0.5	16.0



Can't find what you are looking for?

We can provide unique and customized solutions.
Contact your nearest [Gripwell](#) team for assistance!